

# STATE OF CALIFORNIA WELL COMPLETION REPORT

Refer to Instruction Pamphlet

## No. 758408

DWR USE ONLY - DO NOT FILL IN

STATE WELL NO./STATION NO. \_\_\_\_\_

LATITUDE \_\_\_\_\_ LONGITUDE \_\_\_\_\_

APN/TRS/OTHER \_\_\_\_\_

### GEOLOGIC LOG

ORIENTATION (≅)		DRILLING METHOD		FLUID		DESCRIPTION
Y	HORIZONTAL	Rotary	ANGLE	(SPECIFY)	Bentonite	
Fl	to Fl	Describe material, grain size, color, etc.				
0	3	Top soil				
3	15	Shale gravel				
15	20	White clay				
20	22	Brown clay				
22	90	Shale gravel				
90	95	Lite blue clay				
95	110	Shale gravel				
110	120	Lite blue clay				
120	135	Shale gravel				
135	140	Blue clay				
140	155	Blue shale gravel				
155	160	Blue clay				
160	175	Shale gravel				
175	185	Blue clay				
185	190	Blue shale gravel				
190	195	Blue clay				
195	300	Blue shale gravel				

WELL OWNER

Name Roger & Anna Franklin

Mailing Address 179 Niblick

CITY Paso Robles, Calif. 93446 STATE \_\_\_\_\_ ZIP \_\_\_\_\_

WELL LOCATION

Address Neal Springs Road Lot #4

City Paso Robles

County San Luis Obispo

APN Book 033 Page 321 Parcel 016

Township 278 Range 12E Section 13

Latitude 35 34 17 NORTH Longitude 120 38 24 WEST

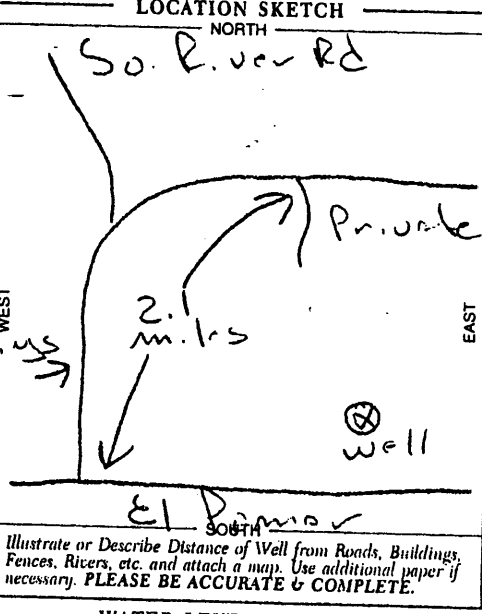

ACTIVITY (≅)

NEW WELL

MODIFICATION/REPAIR

\_\_\_ Deepen

\_\_\_ Other (Specify) \_\_\_\_\_

DESTROY (Describe Procedures and Materials Under "GEOLOGIC LOG")

PLANNED USES (≅)

WATER SUPPLY

Domestic \_\_\_ Public

\_\_\_ Irrigation \_\_\_ Industrial

MONITORING \_\_\_

TEST WELL \_\_\_

CATHODIC PROTECTION \_\_\_

HEAT EXCHANGE \_\_\_

DIRECT PUSH \_\_\_

INJECTION \_\_\_

VAPOR EXTRACTION \_\_\_

SPARGING \_\_\_

REMEDICATION \_\_\_

OTHER (SPECIFY) \_\_\_

NOTE:

ANY PERSON REMOVING THE CAP FROM THIS WELL OTHER THAN MILLER DRILLING CO OR AUTHORIZED CONTRACTOR APPROVED BY US WILL VOID ALL STRUCTURAL WARRANTIES.

Illustrate or Describe Distance of Well from Roads, Buildings, Fences, Rivers, etc. and attach a map. Use additional paper if necessary. PLEASE BE ACCURATE & COMPLETE.

### WATER LEVEL & YIELD OF COMPLETED WELL

DEPTH TO FIRST WATER 195 (Fl.) BELOW SURFACE

DEPTH OF STATIC WATER LEVEL 176 (Fl.) & DATE MEASURED 10-22-01

ESTIMATED YIELD 80@300 (GPM) & TEST TYPE Blow test

TEST LENGTH \_\_\_\_\_ (Hrs.) TOTAL DRAWDOWN \_\_\_\_\_ (Fl.)

\* May not be representative of a well's long-term yield.

TOTAL DEPTH OF BORING 300 (Feet)

TOTAL DEPTH OF COMPLETED WELL 300 (Feet)

DEPTH FROM SURFACE	BORE-HOLE DIA. (Inches)	CASING (S)							
		TYPE (≅)				MATERIAL / GRADE	INTERNAL DIAMETER (Inches)	GAUGE OR WALL THICKNESS	SLOT SIZE IF ANY (Inches)
Fl	to Fl	BLANK	SCREEN	CON-DUCTOR	FILL PIPE				
0	200	9 7/8	X			F480 PVC	5	.265	
200	300	9 7/8	X			F480 PVC	5	.265	.060

DEPTH FROM SURFACE	ANNULAR MATERIAL			
	TYPE			
Fl. to Fl.	CE-MENT (≅)	BEN-TONITE (≅)	FILL (≅)	FILTER PACK (TYPE/SIZE)
0 to 50	X			
50 to 300				Lapis Mix

ATTACHMENTS (≅)

\_\_\_ Geologic Log

\_\_\_ Well Construction Diagram

\_\_\_ Geophysical Log(s)

\_\_\_ Soil/Water Chemical Analyses

\_\_\_ Other \_\_\_\_\_

ATTACH ADDITIONAL INFORMATION, IF IT EXISTS.

CERTIFICATION STATEMENT

I, the undersigned, certify that this report is complete and accurate to the best of my knowledge and belief.

NAME Miller Drilling Company  
(PERSON, FIRM, OR CORPORATION) (TYPED OR PRINTED)

ADDRESS 301 North Main Street Templeton Calif. 93465 AA  
CITY STATE ZIP

Signed [Signature]  
WELL DRILLER/AUTHORIZED REPRESENTATIVE

DATE SIGNED \_\_\_\_\_ C-57 LICENSE NUMBER \_\_\_\_\_



Roger Franklin  
179 Niblick Road  
Paso Robles, CA 93446

Log Number: 02-C687  
Order: J0220  
Project: Franklin  
Received: 01/15/02

### REPORT OF ANALYTICAL RESULTS

SAMPLE DESCRIPTION	SAMPLED BY	SAMPLED		MATRIX	
		DATE @ TIME			
Well # 3	Rod Hewett	01/15/02@12:25		Drinking Water	
ANALYTE	RESULT	* R. L.	UNITS	METHOD	ANALYZED
Total Alkalinity as CaCO3	230	2	mg/L	EPA 310.1	01/25/02
Chloride	40	1	mg/L	EPA 300.0	01/15/02
Total Cyanide	Not Detected	0.01	mg/L	EPA 335.2	01/25/02
Color	Not Detected	1	units	EPA 110.2	01/15/02
Electrical Conductance	620	1	umhos/cm	EPA 120.1	01/15/02
Fluoride	Not Detected	1	mg/L	EPA 300.0	01/15/02
MBAS (Anionic Surfactants)	Not Detected	0.05	mg/L	EPA 425.1	01/16/02
Nitrate as N	Not Detected	0.1	mg/L	EPA 300.0	01/15/02
Nitrate as NO3	Not Detected	0.4	mg/L	EPA 300.0	01/15/02
Nitrite as N	Not Detected	0.1	mg/L	EPA 300.0	01/15/02
Odor	Not Detected	1	TON	EPA 140.1	01/15/02
pH	7.4	0.1	units	EPA 150.1	01/15/02
Sulfate	76	0.5	mg/L	EPA 300.0	01/15/02
Total Dissolved Solids	410	10	mg/L	EPA 160.1	01/20/02
Turbidity	0.5	0.1	NTU	EPA 180.1	01/15/02
Silver	Not Detected	0.01	mg/L	EPA 200.7	01/29/02
Aluminum	Not Detected	0.05	mg/L	EPA 200.7	01/29/02
Arsenic	0.014	0.002	mg/L	EPA 200.9	01/24/02
Barium	Not Detected	0.1	mg/L	EPA 200.7	01/29/02
Beryllium	Not Detected	0.001	mg/L	EPA 200.7	01/29/02
Calcium	68	0.03	mg/L	EPA 200.7	01/29/02
Hardness	320	1	mg/L CaCO3	EPA 200.7	01/29/02
Cadmium	Not Detected	0.001	mg/L	EPA 200.9	01/29/02
Chromium	Not Detected	0.01	mg/L	EPA 200.7	01/29/02
Copper	Not Detected	0.05	mg/L	EPA 200.7	01/29/02
Iron	Not Detected	0.1	mg/L	EPA 200.7	01/29/02
Mercury	Not Detected	0.001	mg/L	EPA 245.1	01/29/02
Potassium	1.0	0.1	mg/L	EPA 200.7	01/29/02
Magnesium	37	0.03	mg/L	EPA 200.7	01/29/02
Manganese	Not Detected	0.03	mg/L	EPA 200.7	01/29/02



# CREEK ENVIRONMENTAL LABORATORIES, INC.

141 SUBURBAN ROAD, SUITE C-5 • SAN LUIS OBISPO, CA 93401 • (805) 545-9838 • FAX (805) 545-0107

Roger Franklin  
179 Niblick Road  
Paso Robles, CA 93446

Log Number: 02-C687  
Order: J0220  
Project: Franklin  
Received: 01/15/02

## REPORT OF ANALYTICAL RESULTS

SAMPLE DESCRIPTION	SAMPLED BY	SAMPLED		MATRIX	
		DATE @ TIME			
Well # 3	Rod Hewett	01/15/02@12:25		Drinking Water	
ANALYTE	RESULT	* R.L.	UNITS	METHOD	ANALYZED
Sodium	22	0.05	mg/L	EPA 200.7	01/29/02
Nickel	Not Detected	0.01	mg/L	EPA 200.7	01/29/02
Lead	Not Detected	0.005	mg/L	EPA 200.9	01/28/02
Antimony	Not Detected	0.006	mg/L	EPA 200.9	01/29/02
Selenium	Not Detected	0.005	mg/L	EPA 200.9	01/23/02
Thallium	Not Detected	0.001	mg/L	EPA 200.9	01/30/02
Zinc	Not Detected	0.05	mg/L	EPA 200.7	01/29/02

\* R.L. - Reporting Limit. 'RESULTS' reported as "Not Detected" means not detected above R.L.

CREEK ENVIRONMENTAL LABORATORIES

Lab Director, Orval Osborne



# DRINKING WATER EVALUATION

"MCL" is Maximum Contaminant Level, the highest acceptable concentration of analyte. Compare these MCL's to your results. **Acceptable RESULTS are less than the MCL's for each analyte.** The MCL's are determined by California Department of Health Services. They are listed in the Code of Regulations, Title 22, Sections 64435 & 64473. "ANALYTE" is the chemical constituent being measured.

"UNITS" are in mg/L (ppm). mg/L = milligrams per liter. ppm = parts-per-million. To convert mg/L to ug/L (ppb): 1 mg/L = 1,000 ug/L. 1 ug/L = 0.001 mg/L.

## PRIMARY DRINKING WATER STANDARDS

Primary standards analytes have potential toxic effects when above the MCL.

<u>ANALYTE</u>	<u>MCL</u>	<u>UNITS</u>	<u>ANALYTE</u>	<u>MCL</u>	<u>UNITS</u>
Aluminum	1	mg/L	Nickel	0.1	mg/L
Antimony	0.006	mg/L	Selenium	0.05	mg/L
Arsenic	0.05	mg/L	Silver	0.05	mg/L
Barium	1	mg/L	Thallium	0.002	mg/L
Beryllium	0.004	mg/L	Zinc	5	mg/L
Cadmium	0.005	mg/L	Cyanide	0.2	mg/L
Chromium	0.05	mg/L	Fluoride	2	mg/L
Lead	0.05	mg/L	Nitrate as NO3	45	mg/L
Mercury	0.002	mg/L	Nitrite	1	mg/L

## SECONDARY DRINKING WATER STANDARDS

These aesthetic standards analytes may contribute to undesirable characteristics when over MCL's, but are not threats to human health.

<u>ANALYTE</u>	<u>MCL</u>	<u>UNITS</u>	<u>ANALYTE</u>	<u>MCL</u>	<u>UNITS</u>
Copper	1	mg/L	Color	15	Units
Iron	0.3	mg/L	Odor	3	Units
Manganese	0.05	mg/L	Turbidity	5	Units
MBAS	0.5	mg/L			

	<u>MCL: RECOMMENDED</u>	<u>UPPER</u>	<u>SHORT TERM</u>	<u>UNITS</u>
Chloride	250	500	600	mg/L
Sulfate	250	500	600	mg/L
Electrical Conductance	900	1600	2200	umhos/cm
Total Dissolved Solids	500	1000	1500	mg/L

Analytes not listed above have no MCL established, so any level is acceptable. NOTE: Organic chemicals, solvents, pesticides, herbicides, radioactivity, asbestos or bacteria are not included in above tests.